

Composite dry sliding bushings, inch dimensions

Principal dimensions			Basic load ratings		Mass	Designation
d	D	B	dynamic C	static C0		
mm			kN		kg	-
9,525	11,90625	19,05	14,6	45,5	0,0058	PCZ 0612 B

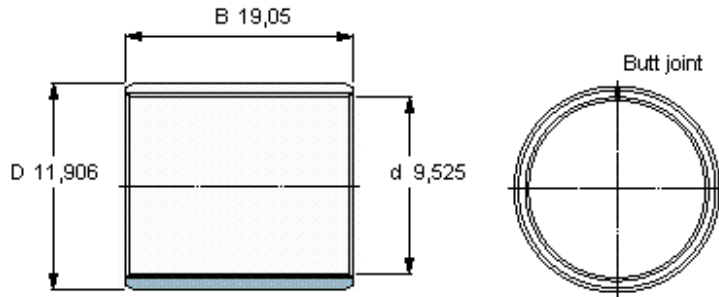

Specific load factor
Material constant

K 80
K_M 480